

STAGE - APPROX: 34' WIDE X 16" DEPTH (12" AT SIDES)

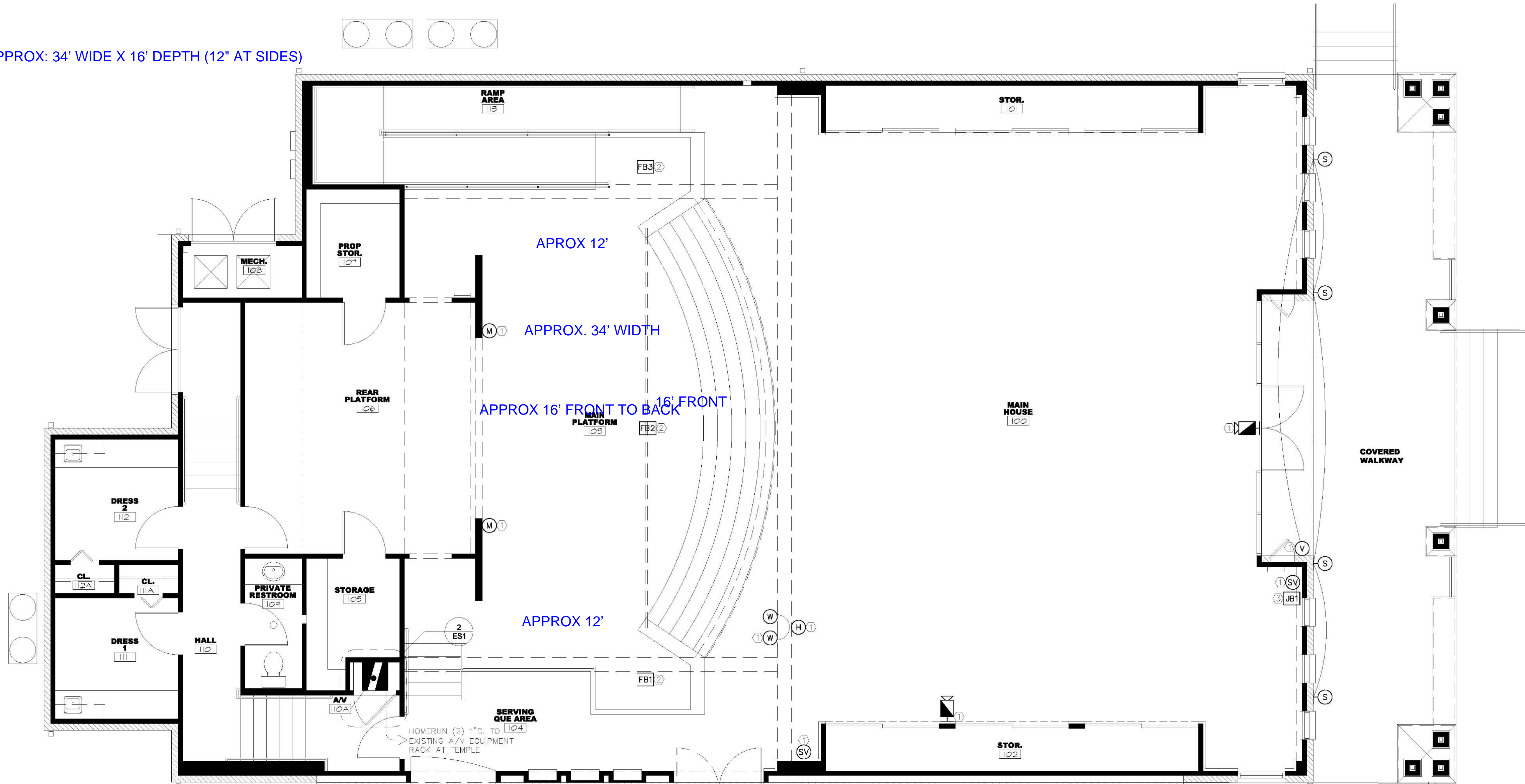

1 A/V SYSTEM FLOOR PLAN
SCALE: 1/4" = 1'-0"
NORTH

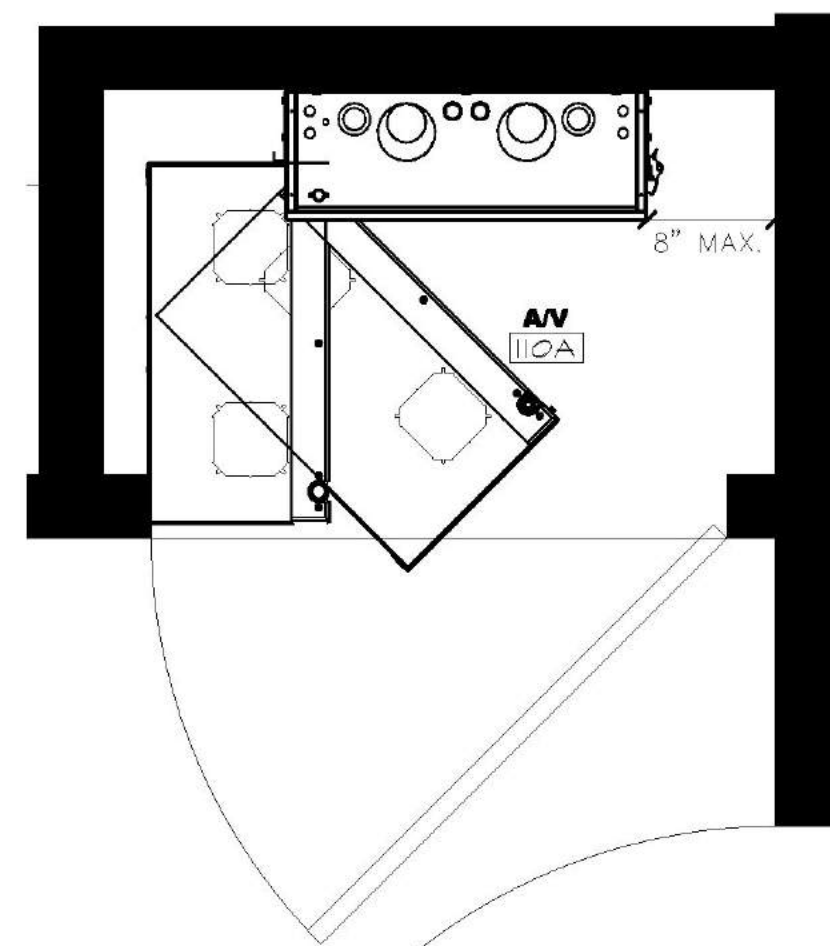

2 A/V CLOSET LAYOUT
SCALE: 1" = 1'-0"
NORTH

ELECTRICAL LEGEND

SYM	DESCRIPTION	ACCEPTABLE TYPES/NOTES
JB#	3" DEEP, TRIPLE GANG BOX MOUNTED AT 2'-0" AFF FOR A/V CONNECTOR PANEL.	PROVIDE (2) 1" C. HOMERUN TO A/V EQUIPMENT RACK. PROVIDE 120VAC DUPLEX ADJACENT.
FB#	FLOOR BOX RECESSED IN FINISH FLOOR (SEE ELECTRICAL). COORDINATE WITH A/V CONTRACTOR TO INSTALL RECEPTICAL.	PROVIDE 120VAC DUPLEX IN BOX. COORDINATE PLACEMENT WITH LECTERN LOCATION.
VF	3" DEEP, DOUBLE GANG BOX MOUNTED IN FINISH CEILING FOR VIDEO PROJECTOR.	PROVIDE 120VAC DUPLEX ADJACENT ON DEDICATED CIRCUIT.
S	SPEAKER TRIM RING MOUNTED AT FINISH CEILING.	OBTAIN FROM DIVISION 27. INSTALLED BY DIVISION 26. CONNECT UNITS WITH PLENUM RATED CABLE WHERE APPLICABLE.
HS	3" DEEP, SINGLE GANG BOX MOUNTED AT 8'-0" AFF. COORDINATE LOCATION WITH ARCHITECT.	
SC	3" DEEP, DOUBLE GANG BOX INSTALLED IN FINISH CEILING FOR SPEAKER CLUSTER.	
V	3" DEEP, SINGLE GANG BOX MOUNTED AT ELECTRICAL SWITCH HEIGHT FOR VOLUME CONTROL.	
SV	3" DEEP, SINGLE GANG BOX MOUNTED AT ELEC. SWITCH HEIGHT FOR SOURCE/VOLUME CONTROL.	
H	3" DEEP, SINGLE GANG BOX MOUNTED 12" BELOW FINISH CEILING FOR ALS ANTENNA.	
W	3" DEEP, SINGLE GANG BOX W/ COVER MOUNTED 12" BELOW FINISH CEILING FOR WIRELESS MICROPHONE ANTENNAE.	SPACE BOXES 12" APART O.C. AND CONNECT WITH 3/4" C.
M	3" DEEP, TRIPLE GANG BOX MOUNTED AT ELECTRICAL OUTLET HEIGHT FOR MICROPHONE INPUT.	
W	3" DEEP, SINGLE GANG BOX MOUNTED AT 8'-6" AFF FOR WALL MOUNTED PTZ CAMERA.	
W	WALL MOUNTED EQUIPMENT RACK FOR AUDIO/VISUAL EQUIPMENT. MOUNTED AT 42" AFF.	PROVIDED BY DIVISION 27. INSTALLED BY DIVISION 26. DIVISION 26 TO PROVIDE 120VAC DUPLEX ON DEDICATED CIRCUIT ADJACENT.
W	12" X 12" X 4" METAL JUNCTION BOX RECESSED BEHIND EQUIPMENT CABINET MOUNTED AT +52" AFF.	SEE ELECTRICAL NOTE 3 BELOW. STUB CONDUIT INTO BACK BOX.

ELECTRICAL NOTES:

- ALL CONDUIT SHOWN IS 3/4" DIAMETER, UNLESS NOTED OTHERWISE.
- ALL CONDUIT SHOWN IS FOR SCHEMATIC PURPOSES ONLY. COORDINATE ACTUAL CONDUIT RUNS WITH ARCHITECTURAL CONDITIONS.
- DIVISION 26 TO PROVIDE THE FOLLOWING FROM A SINGLE A/V PANEL:
 - (2) 20A CIRCUITS STUBBED INTO WALL MOUNTED SURGE PROTECTORS AT A/V EQUIPMENT RACK.
 - 120 VAC DUPLEX OUTLETS ADJACENT TO A/V WALL BOXES AS NOTED.
 - INSULATED #4 GROUND WIRE FROM ELECTRICAL PANEL TO EACH EQUIPMENT CABINET.
 - DEDICATED 20A CIRCUITS AS NOTED, EACH WITH DEDICATED GROUND AND NEUTRAL WIRES.
- THIS DRAWING IS FOR DIVISION 27 SOUND CONTRACTOR'S REFERENCE ONLY. ALL WORK ON 'ES' DRAWINGS IS BY DIVISION 26 ELECTRICAL CONTRACTOR. REFER TO DIVISION 27 SPECIFICATIONS.
- PROVIDE WOOD BLOCKING AS REQUIRED TO REINFORCE CEILING MOUNTED JUNCTION BOXES.

KEYED NOTES:

- HOMERUN (1) 3/4" C. TO A/V EQUIPMENT RACK A/V 110A.
- HOMERUN (1) 1" C. TO A/V EQUIPMENT RACK A/V 110A.
- HOMERUN (1) 3/4" C. AND (1) 1" C. TO A/V EQUIPMENT RACK A/V 110A.

consultants in acoustics & electronic media system design

dickensheets
DESIGN ASSOCIATES
www.dickensheets.com
12333 hwy 281, suite 200, austin, texas 78750 ph 512.331.8877 fax 512.331.8947

Copyright Architecture TDC. Architecture TDC expressly reserves its common law copyright and other property rights regarding these plans. The plans and arrangements depicted herein are the sole property of Architecture TDC and shall be released by the registrant. The plans may not be reproduced, changed, or copied in any form or manner whatsoever nor are they to be loaned or assigned to any third party without first obtaining the express written permission of Architecture TDC.
DO NOT SCALE FROM THESE DRAWINGS.

architects & planners
2027 seasonal
austin, Texas 78748
(512) 282-0695

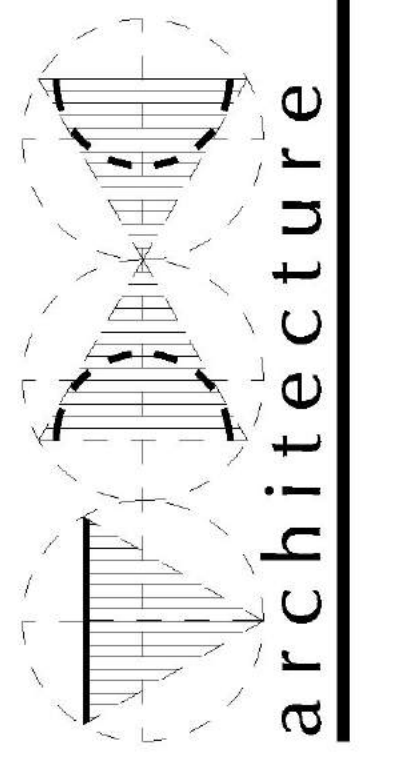

REGISTERED
PROFESSIONAL
ARCHITECT
STATE OF TEXAS

BID SET - NOT FOR CONSTRUCTION

**SRI SHIRDI SAI BABA TEMPLE OF AUSTIN
COMMUNITY CENTER ADDITION**

2509 W. NEW HOPE DR.
CEDAR PARK, TEXAS 78613

JOB NO.:
DATE: 4-13-12
DESIGN: DDA
DRAWN: DAH
CHECKED: KRJ
REV'D:

SHEET NO.
ES1
A/V SYSTEMS
FLOOR PLAN